

5560S-5565S

TENSIONMETER

Load cell specially designed to measure the tension force applied to a cable or a rope.

- Easy and fast mounting
- Designed for static rope tension measurement
- Protection : IP67
- Wide range of cable's diameters : from 3 up to 90 mm (0,11 to 3,5")
- Material:
 - o Stainless steel (5560S)
 - o Nickel plated steel (5565S)
- Available options (non exhaustive list) :
 - o ATEX Ex ia IIC T6 to T4 certified (hazardous area)
 - o Zone 2 to zone 0
 - o Amplified output signal (4..20 mA or 1..5V)
 - o Subsea version (IP 68)



Model 5560S - 30 t

The SENSY's load cells 5560S and 5565S are perfectly designed for the following applications:

- Hookload sensor for drilling, mud-logging, ...
- Tension measurement of cable, rope, shrouds and riggings of electric pylons, transmission antenna's, towers, flare masts, barge mooring lines, ...
- Tension measurement for suspended bridges and foot-bridges, big tops, ...

CAPACITIES :

5560S - 5565S : 1 to 80 t
on cable

TECHNICAL DATA		
Combined error (non-linearity + hysteresis)	% F.S.	2 - 5 *
Reference temperature	°C	23
Nominal temperature range	°C	- 10...+ 45
Service temperature range	°C	- 30...+ 70
Storage temperature range	°C	- 50...+ 85
Temperature coefficient of the sensitivity	%/10°C	< ± 0.1
Temperature coefficient of zero signal	% F.S./10°C	< ± 0.1
Nominal sensitivity	mV/V	1
Input / Output resistance	Ohm	350 ± 20
Insulation resistance (50V)	MOhm	> 5000
Nominal excitation voltage	V	10
Nominal range of the excitation voltage	V	2 ... 12
Safe load limit	% F.S.	200
Breaking load	% F.S.	> 500

F.S.: full scale Specifications subject to change without notice

* Depending on rope material and on site calibration

LOAD CELL

model 5560S
model 5565S

stainless steel
alloy steel

TENSIOMETER ON ROPE

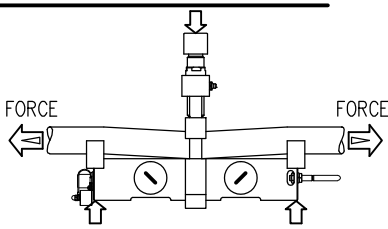

Range : 1-80t For cables 3 to 90 mm IP67 (IP68 Option)



ATEX certified

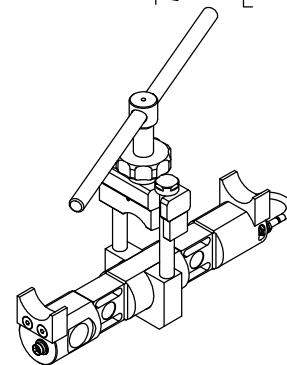
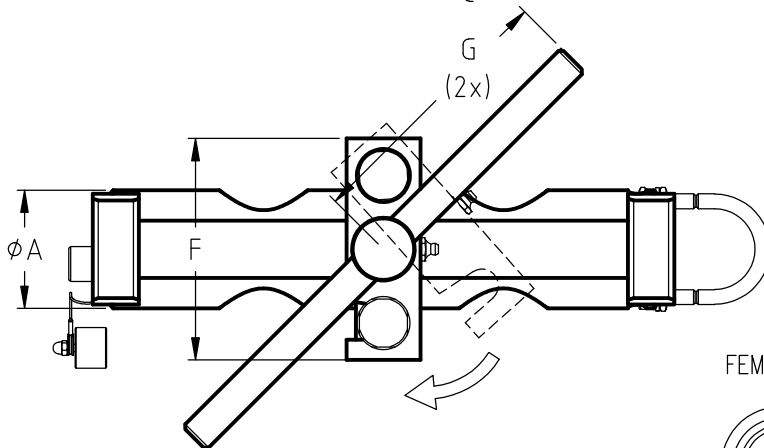
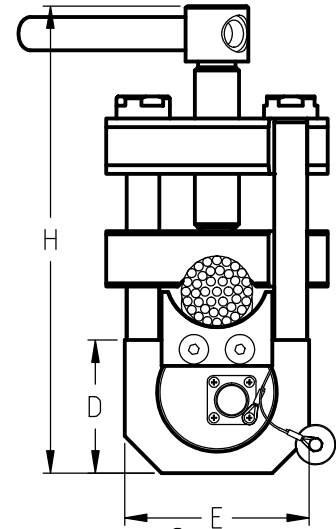
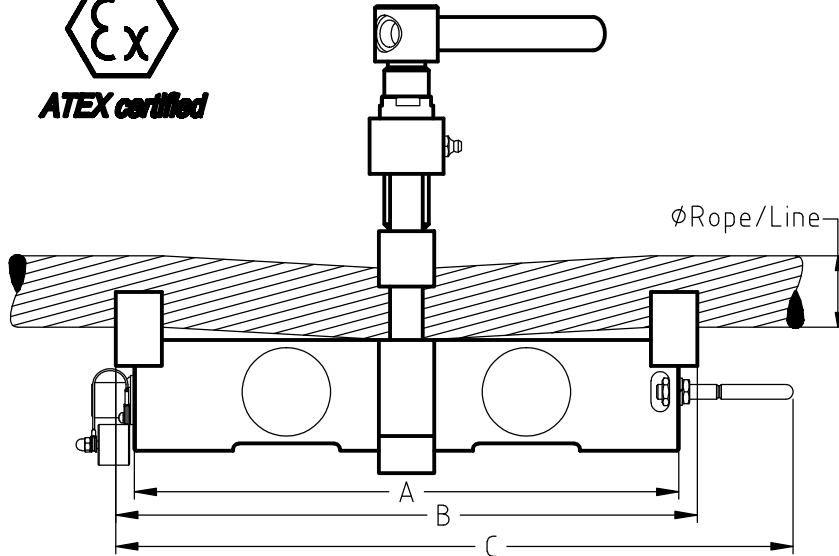

FEMALE-MALE CONNECTOR DIN 45322

CONTACT N°

- 1 Excitation - Yellow
- 2 Signal + Green
- 3 Signal - White
- 4 Excitation + Brown
- 5 Sense - Grey
- 6 Sense + Pink

Standard cable

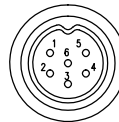

Cable screen not connected to transducer
Option f : Cable screen connected to transducer
(6 wires cable in option)

CAPACITIES	$\phi\text{Rope/Line}$	ϕA	A	B	C	D	E	F	G	H (Min)	H (Max)	Weight (kg)
5 t	Min 18 -Max 26	64	295	315	367	72	100	120	217	224	264	± 10.4
6 t	Min 8 - Max 12	64	295	315	367	72	100	120	217	214	246	± 10.25
6 t	Min 12 -Max 20	64	295	315	367	72	100	120	217	224	264	± 10.4
10 t	Min 8 - Max 20											± 10.4
15 t	Min 22 -Max 50.8											± 11
15 t	Min 32 -Max 52	64	360	370	427	72	100	120	217	263	310	± 12.5
30 t	Min 22 -Max 50.8	64	295	315	367	72	100	120	217	224	284	± 11
45 t												
75 t	Min 38 -Max 58	74	405	415	472	89	150	147	324.5	296	365	± 26

* Other sizes and capacities on request